



**Medication**

- Bupivacaine
  - 0.125%     0.25%
  - 0.5%       other \_\_\_\_\_
- Ropivacaine
  - 0.2%       other \_\_\_\_\_
- Other \_\_\_\_\_

**Call your doctor for all medical questions.**

**Contact**

Doctor: \_\_\_\_\_

Phone: \_\_\_\_\_

**Next Appointment**

Date: \_\_\_\_\_ Time: \_\_\_\_\_

**Special Instructions**

---



---



---

**If you would like to learn more about post-op pain relief options visit: [www.AskYourSurgeon.com](http://www.AskYourSurgeon.com)**

CAUTION: FEDERAL LAW (U.S.A.) RESTRICTS THIS DEVICE TO SALE BY OR ON THE ORDER OF A PHYSICIAN.

Manufactured by: I-Flow Corporation  
Lake Forest, CA 92630

© ON-Q and PainBuster are registered trademarks of I-Flow Corporation.



European Representative:  
MPS Medical Product Service GmbH  
Borngasse 20, 35619 Braunfels, Germany

**Immediately report any of the following symptoms to your doctor: (Close the clamp on the pump tubing to stop the infusion.)**

- Increase in pain
- Redness, swelling, pain, and/or discharge at the catheter site
- Dizziness, light-headedness
- Blurred vision
- Ringing, buzzing in your ears
- Metal taste in your mouth
- Numbness and/or tingling of the mouth and lips
- Nausea/vomiting
- Drowsiness
- Other side effects:

**24-Hour Product Support Hotline  
800-444-2728**

**Numbness:** Be aware that you may experience loss of feeling at and around the surgical area. If numbness occurs, take proper measures to avoid injury.

**Precautions**

- ◆ Do not reuse.
- ◆ Protect the pump and catheter site from water according to your doctor's instructions.

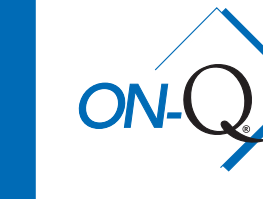

**Patient Guidelines**

Your Doctor's Information

[www.AskYourSurgeon.com](http://www.AskYourSurgeon.com)

1302911F  
02/2004

[www.AskYourSurgeon.com](http://www.AskYourSurgeon.com)

# Patient Guidelines



[www.AskYourSurgeon.com](http://www.AskYourSurgeon.com)

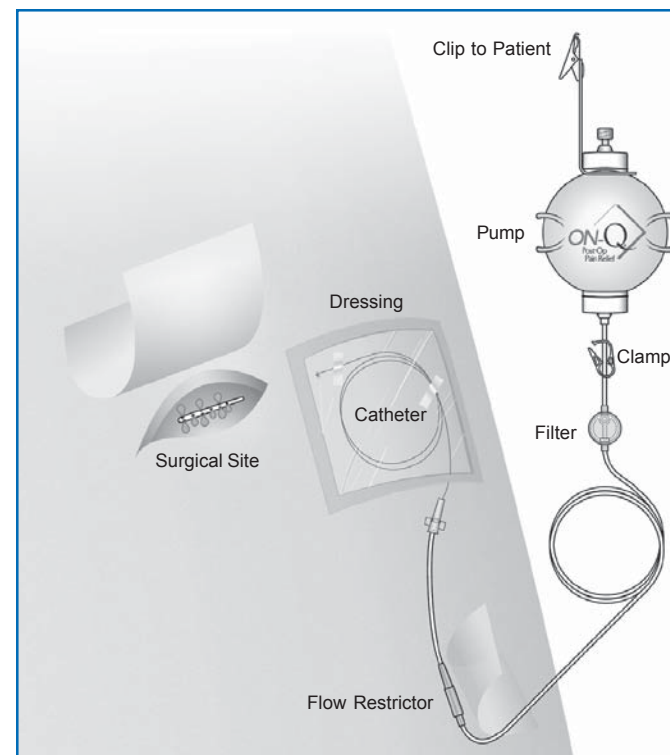

## How the ON-Q PainBuster Works

The ON-Q PainBuster Post-Op Pain Relief System includes a small round pump filled with a local anesthetic medicine to treat your pain after surgery.

The pump is attached to a catheter (small tube) near your incision site. The pump automatically delivers the medicine at a very slow flow rate.

## During the Infusion

The ON-Q PainBuster pump is completely portable and can be attached to your clothing or placed in a carrying pouch.

- ◆ It is important that the lower part of the pump tubing with the flow restrictor be next to your skin to ensure flow accuracy. Tape if necessary.

As the medicine is delivered, the pump will gradually become smaller.

- ◆ Do not expect to notice a decrease in the size of the pump on an hourly basis.
- ◆ Do not squeeze the pump. The pump provides the force needed to deliver the medicine.

## End of Infusion

- ◆ All your medicine has been delivered when the infusion time has passed and the ON-Q PainBuster pump is no longer full. A hard tube can be felt in the middle of the pump.

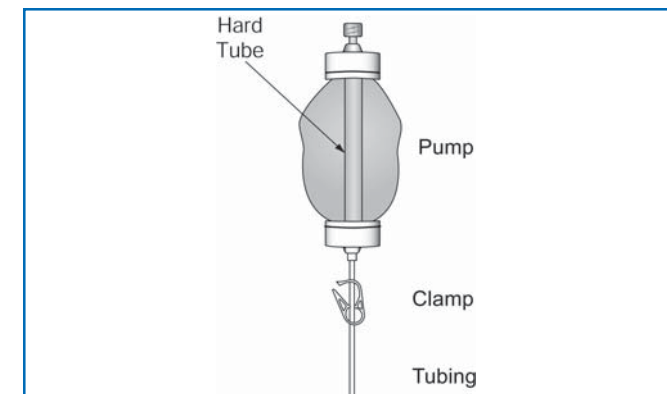

## Removal of Catheter

If your doctor has instructed you to remove the catheter, then follow their instructions keeping in mind these key steps:\*

- ◆ Remove the dressing covering the catheter site.



- ◆ Grasp the catheter close to the skin and gently pull on the catheter. It should be easy to remove and not painful. Do not tug or quickly pull on the catheter during removal. If it becomes hard to remove or stretches, then STOP. Call your doctor. Continued pulling could break the catheter.

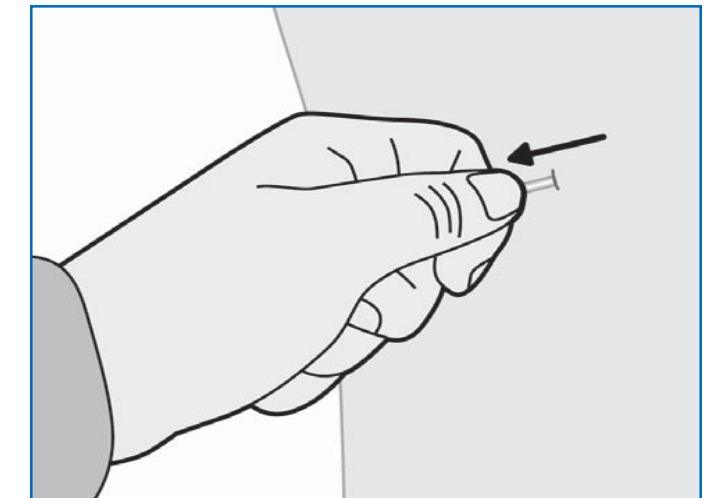

- ◆ Do not cut or pull hard to remove the catheter.
- ◆ After you remove the catheter, check the catheter tip for the black marking to ensure the entire catheter was removed. Call your doctor if you don't see the black marking.

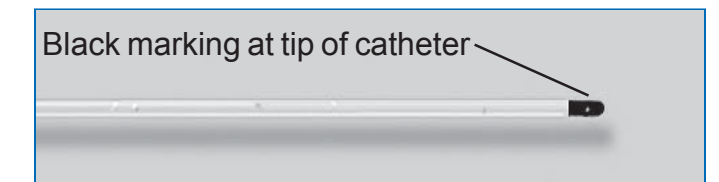

- ◆ Place a bandage over the catheter site as instructed by your doctor.

\*Repeat these steps for other catheter site if you have more than one catheter.

Call your doctor if you have:

- ◆ Redness, warmth or excessive bleeding from the catheter site.
- ◆ Pain, swelling or a large bruise around the catheter site.